



# EZ Claw Center Post Mount

## Installation Instructions

Item # EZCCPM | The **EZ Claw Center Post Mount** is a six-foot, stand-alone, bolt-on bracket that accepts tensioners and accessories when the back of the semi cab is inaccessible or the tractor's wheelbase is too long.

### Kit Includes:

- (1) Base Plate Member (Part A)
- (1) Upright Support (Part B)
- (2) Center Post (Part C)
- (1) Universal Head Mount (Part D)
- (4) Frame Anchor (Part E)
- (1) Base Support Member (Part F)
- (8) 1/2-13 x 13" Long G8 Flange Bolt
- (8) 1/2-13 G8 Flange Lock Nut-YZN
- (36) 3/8-16x1" Long G8 Flange Bolt
- (36) 3/8-16 Flange Locknut

### Recommended Tools for Installation:

- (1) Battery Powered Impact Driver
- (1) 3/4" Socket
- (1) 3/4" Open Ended Wrench
- (1) 9/16" Socket
- (1) 9/16" Open Ended Wrench



# EZ CLAW CENTER POST MOUNT PARTS LIST



**PART A**  
BASE PLATE MEMBER  
EZ-0241  
QUANTITY: 1



**PART B**  
UPRIGHT SUPPORT  
EZ-0242  
QUANTITY: 1



**PART C**  
CENTER POST  
EZ-0243  
QUANTITY: 2



**PART D**  
UNIVERSAL HEAD MOUNT  
EZ-0244  
QUANTITY: 1



**PART E**  
FRAME ANCHOR  
EZ-0245  
QUANTITY: 4



**PART F**  
BASE SUPPORT MEMBER  
EZ-0248  
QUANTITY: 1



**MOUNTING HARDWARE**  
(QTY 8) 1/2-13 x 13" LONG G8 BOLT  
(QTY 16) 1/2-13 G8 FLAT WASHER-YZN  
(QTY 8) 1/2-13 G8 LOCK NUT-YZN



**ASSEMBLY HARDWARE**  
(QTY 36) 3/8-16x1" LONG G8 FL BOLT  
(QTY 36) 3/8-16 FL LOCKNUT

# Installation Instructions

1

**FP0 in-use to come**

## **Attach Part A to Part C.**

Locate Base Plate Member (Part A) and Center Post (Part C). Set Part C on Part A and install nuts and bolts loosely through the four holes in the back and two holes in the bottom. Ensure head of the bolts are oriented as shown in Fig. 1 for proper frame rail clearance. After all nuts and bolts are installed, tighten all bolts.

2

**FP0 in-use to come**

## **Install nuts and bolts on Part F.**

Locate Base Support Member (Part F). Install on assembly from Step 1. Loosely install four bolts and nuts through the front of Part F and six bolts from the bottom as shown. After all bolts are installed, proceed with tightening, making sure slotted holes for the frame are aligned.

3

**FP0 in-use to come**

## **Connect Part B to Part C.**

Locate Upright Support (Part B) and connect to back side of Center Post (Part C) with four nuts and bolts. Do not tighten bolts at this time. Set assembly aside.

4

**FP0 in-use to come**

## **Attach Part D and Part C.**

Locate the second Center Post Upright (Part C) and the Universal Head Mount (Part D). Set Part D on top of Part C and install nuts and bolts through the four holes in the back and two holes on top. After all bolts are installed, proceed with tightening.

5

**FP0 in-use to come**

## **Combine Head Assembly and Base Assembly.**

Set Head Assembly (Step 4) on top of Base Assembly (Step 1-3). Loosely install four nuts and bolts through Part B and two nuts and bolts in the center to join in the uprights. After all nuts and bolts are installed, tighten all bolts.

6

**FP0 in-use to come**

## **Stand Center Post Mount up.**

Stand assembled Center Post Mount in desired location on the frame rails of

7

**FP0 in-use to come**

### **Install Mounting Bolts.**

Locate 1/2" Mounting Bolts from the included Mounting Hardware Kit. Install 13" bolts down through the base of the Center Post Mount avoiding any frame hardware that may exist on the truck.

8

**FP0 in-use to come**

### **Install Frame Anchors**

Locate Frame Anchor (Part E) and 1/2" flange nuts. Install Part E on two of the bolt assemblies making sure it crosses under the frame. Install 1/2" lock nuts. Repeat for the other three frame anchors.

9

**FP0 in-use to come**

### **Special Case.**

If 1/2" Mounting Bolts are not used in the front hole of the Base Support Member (Part F), extra 3/8" bolts and nuts are included to secure these components.

10

**FP0 in-use to come**

### **Install the EZ Claw Line Saver.**

Locate the EZ Claw Line Saver(s) (sold separately) and install on the universal head mount (see Fig. 3), utilizing mounting hardware supplied with the Line Saver. Ensure the Line Saver(s) are mounted so the cable extends from the top, guiding over the stainless steel guide roller as shown.

11

**FP0 in-use to come**

### **Attach Hose Assembly.**

Using an EZ Claw Sling (EZCS) or Hose & Cable Block (EZCHCH38), attach the EZ Claw Line Saver cable to the hose assembly.

Figure 1

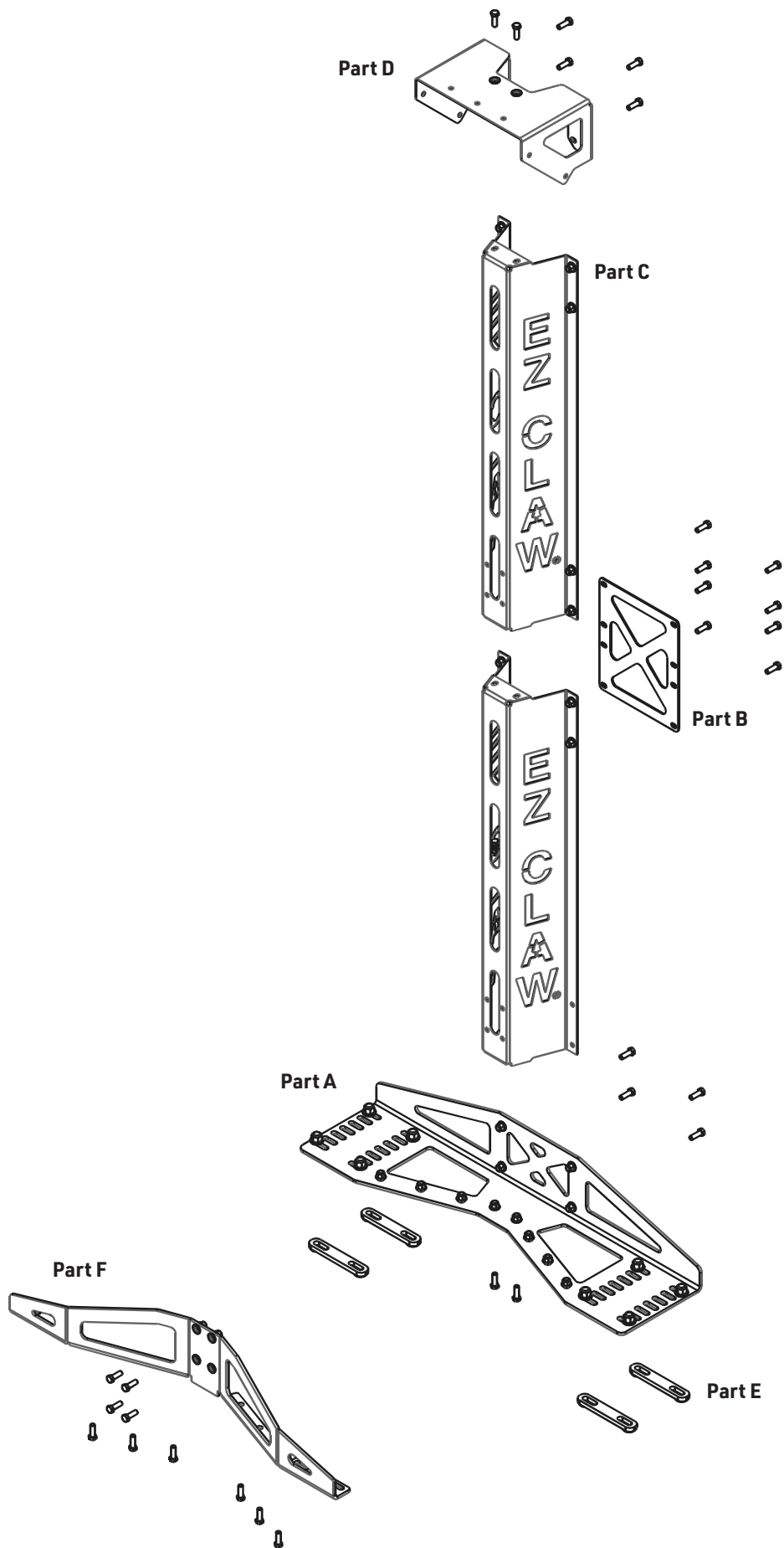

Figure 2

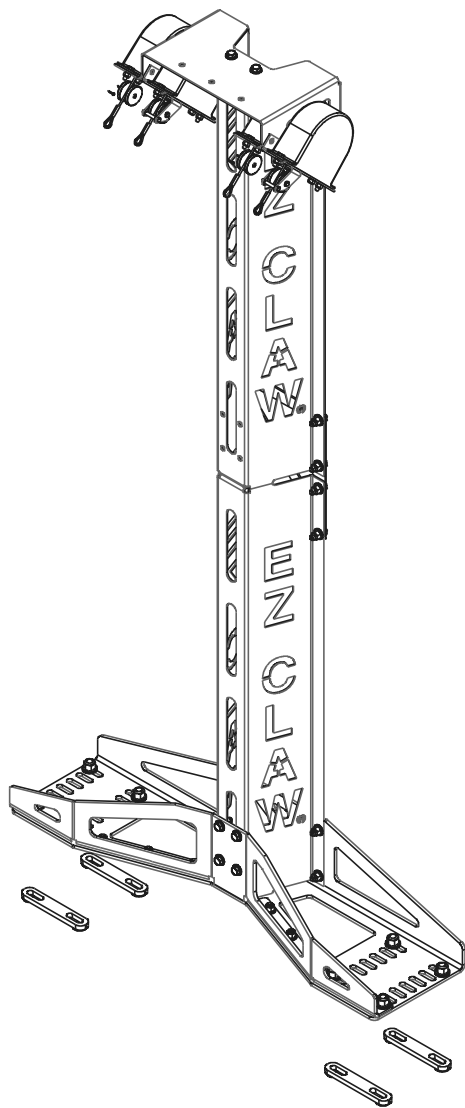
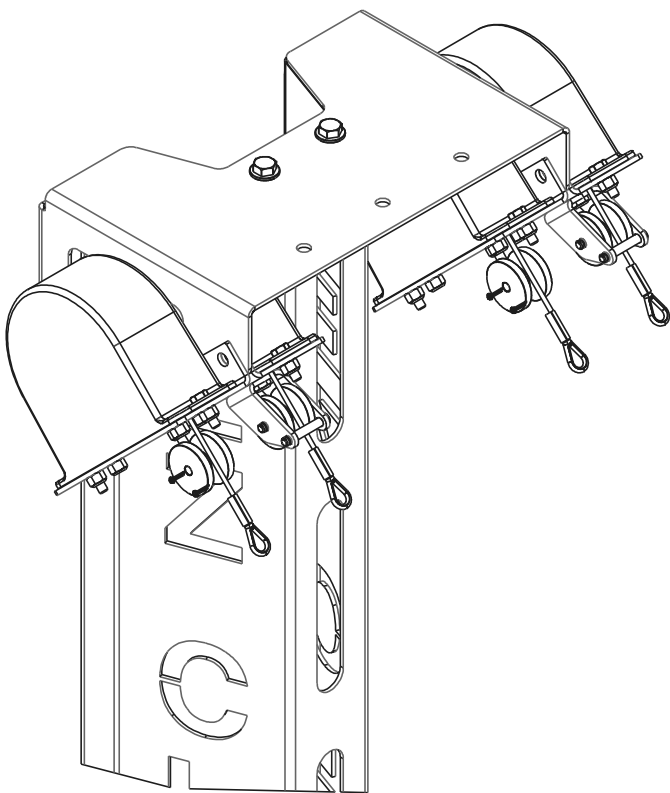

Figure 3



SCALE 0.500